

ALLDAY  
& MILLER



Shelley Close, Hayes, UB4 0QP  
£1,800

 2  1  1  D



## Shelley Close, Hayes, UB4 0QP

**£1,800**

- Two Double Bedrooms
- Modern Bathroom
- Separate Smart Kitchen
- Front Garden
- Newly Refurbished
- Large Reception Room
- Fitted Wardrobes
- Sought After Location

## Description

Set within a Cul-de-sac location, this two bedroom maisonette boasts bright and spacious interiors with a recently renovated kitchen & bathroom. The property is positioned in North Hayes, within the catchment area for Grange Park School and Hayes Park School.

This property comprises of an inviting entrance porch with stairs leading to the first floor, large reception room filled with ample of natural lighting, two generously sized double bedrooms with fitted wardrobes, modern kitchen and family bathroom.

To the front is a low maintenance garden mainly laid to lawn which leads you to the accommodation.

## Situation

Shelley Close situated just off Warley Road with its easy access to a number of local amenities including the Uxbridge Road with its variety of shops, cafes and restaurants. A number of highly regarded schools including Hayes Park and Whitehall Junior school. A number of road links with the M4/M25 and the A40 all within a short drive. Hayes and Harlington station being just a 10 minute drive with the Elizabeth Line giving easy links to Central London.

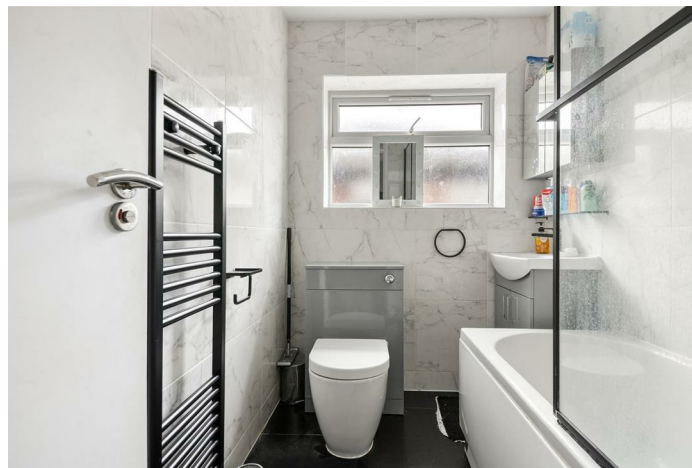

## Floor Plans

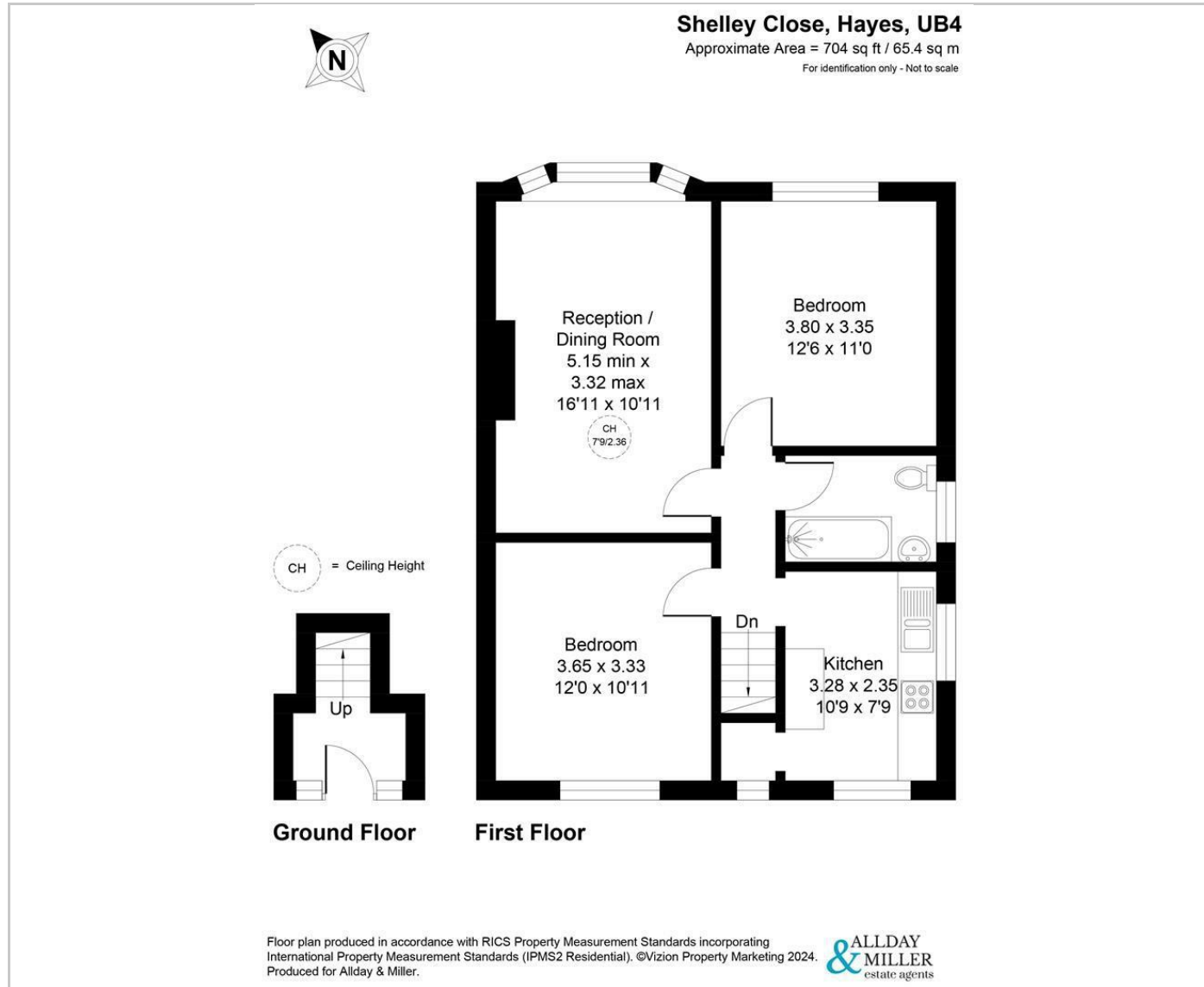

## Area Map

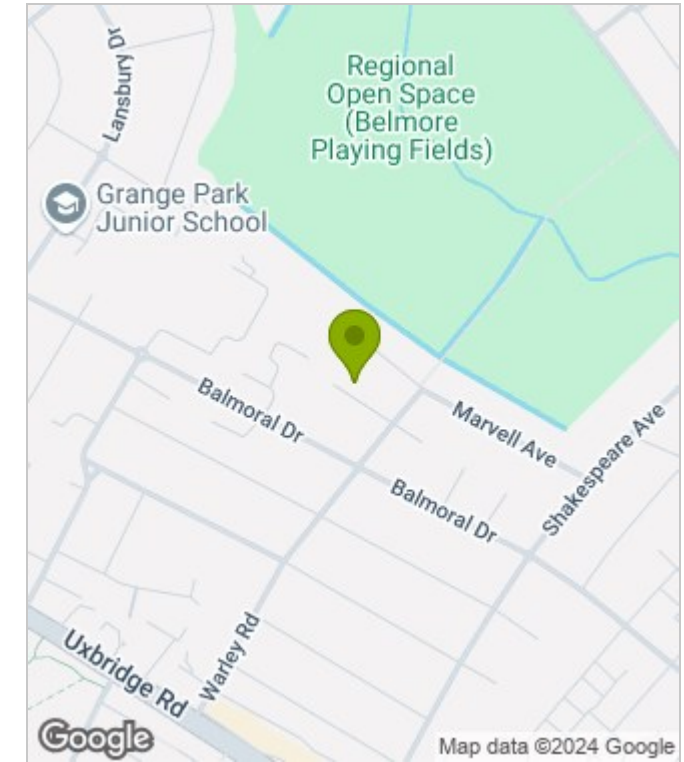

## Energy Performance Graph

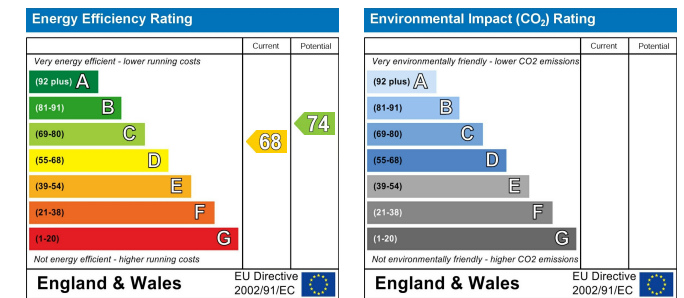

These particulars, whilst believed to be accurate are set out as a general outline only for guidance and do not constitute any part of an offer or contract. Intending purchasers should not rely on them as statements of representation of fact, but must satisfy themselves by inspection or otherwise as to their accuracy. No person in this firm's employment has the authority to make or give any representation or warranty in respect of the property.